

# The Ultimate Switch™ from Greer®

Quite simply, the most advanced anti two-block switch in the world.

The Ultimate Switch™ from Greer Company is the latest innovation in A2B switches, with added protection against two-blocking situations for crane operators and ground personnel. As crane operations become more challenging, the Ultimate Switch offers advanced features that address the need for a smaller footprint on boom heads, easy cable replacement, no-hassle mounting flexibility, and dramatically less cable wear.

## Smaller Footprint

Fits easily on crowded boom heads

## Universal Mounting Adapter

Enables easy switch replacement when converting from a competitor switch.

## 360° Rotation of the Switch Cable

Eliminates cable "bird nesting."

## Advanced Electrical Interface

Offers a quick disconnect feature for easy cable replacement, making switch removal unnecessary.

## Travel Mode Lockout Pin and Flag

Easily removed for crane operations and reinstalls quickly for rigging and travel operations.

## Quick Connect Clip

Designed for quick main and jib mounting. Spring clip is quickly removed providing easy and rapid installation or replacement.

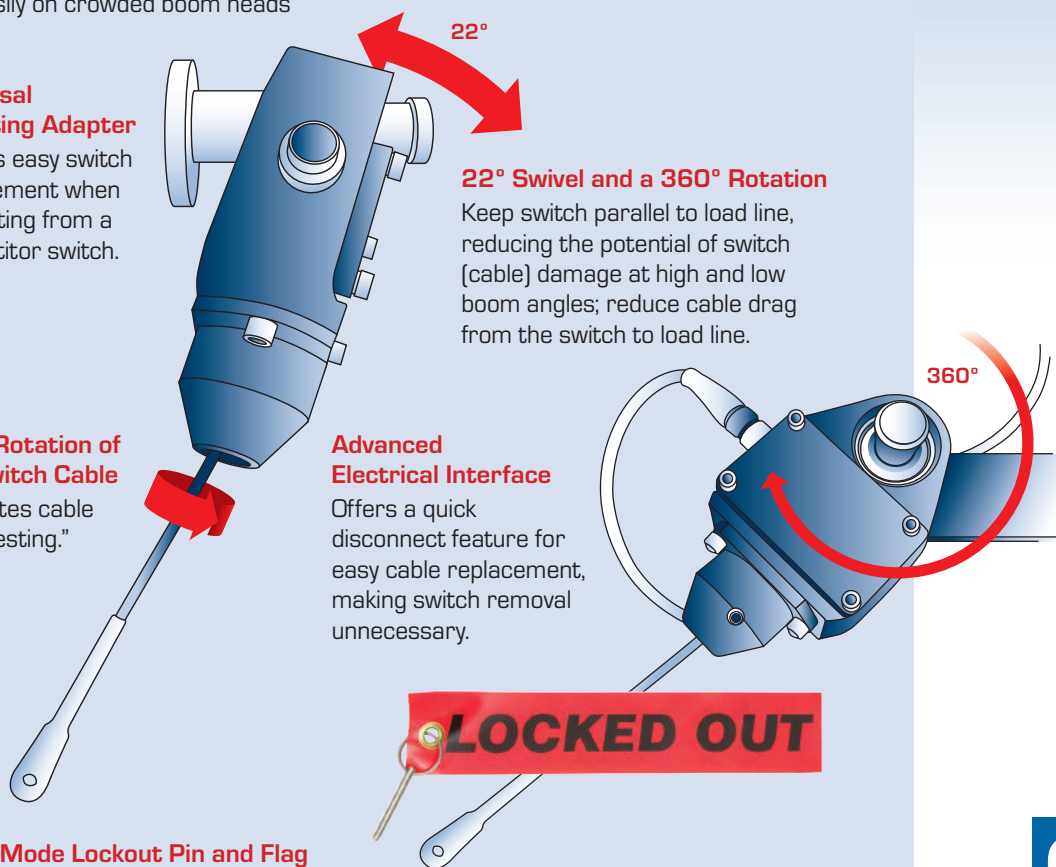

Consider Yourself Warned.™



Infrastructure | Energy | Recovery

[www.team-twg.com](http://www.team-twg.com)

TWG is a global leader in standard and engineered winch, gearbox and electronic monitoring systems.

USA – DP Winch, Gear Products, Greer and Tulsa Winch:  
Canada – LANTEC, Pullmaster:  
Latin America:  
Europe:

[sales@team-twg.com](mailto:sales@team-twg.com)  
[sales@team-twg.ca](mailto:sales@team-twg.ca)  
[sales-BR@team-twg.com](mailto:sales-BR@team-twg.com)  
[salesEU@team-twg.com](mailto:salesEU@team-twg.com)

TWG Headquarters  
11135 S. James Ave.  
Jenks OK 74037-1731 USA  
Phone: +1-918-298-8300

dp Winch | Gear Products | Greer Company | LANTEC | Pullmaster | Tulsa Winch